

**Acceptable slab on grade for
pier supported manufactured home
produced on or after April 1, 2007.**

[Comm 21.40 (1)]

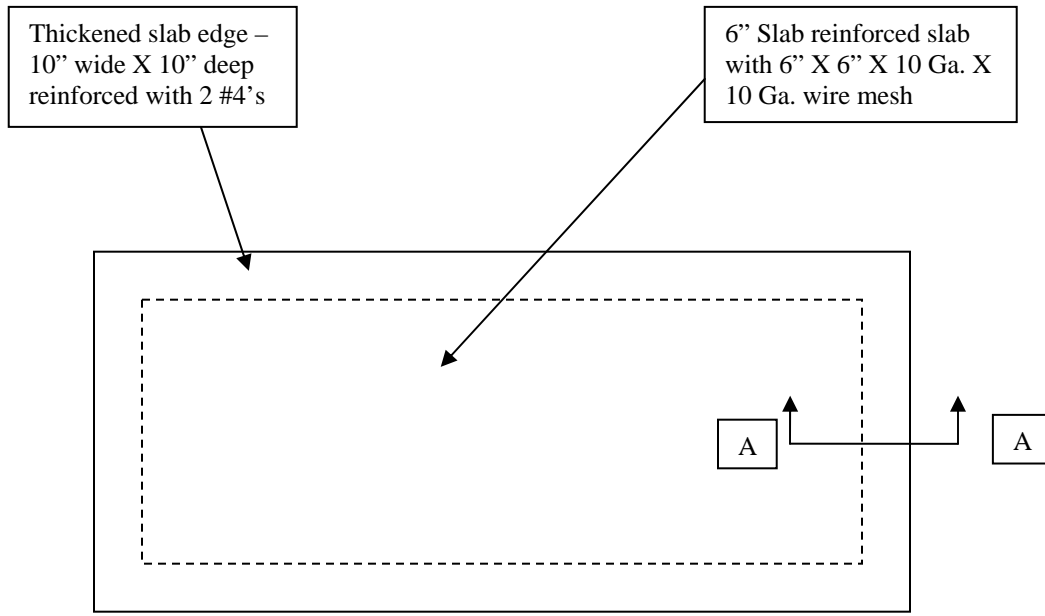

Thickened slab edge –
10" wide X 10" deep
reinforced with 2 #4's

6" Slab reinforced slab
with 6" X 6" X 10 Ga. X
10 Ga. wire mesh

Plan View

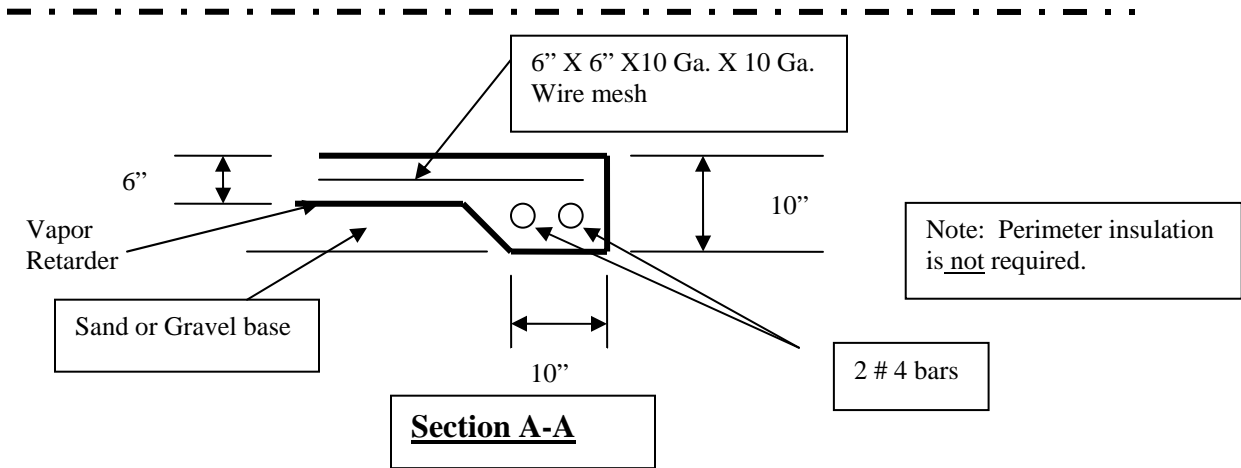

6" X 6" X 10 Ga. X 10 Ga.
Wire mesh

6"
Vapor
Retarder

Sand or Gravel base

10"

Section A-A

2 # 4 bars

Note: Perimeter insulation
is not required.

Limitations:

1. Minimum 3,000 psi Concrete. [3285.312 (b) (ii)]
2. Rebar and mesh at least grade 40.
3. Soil Bearing capacity at least 2,000 psf [Comm 21.40 (2) (b) 2. and 3285.312 (b) (ii)]
4. Placed on undisturbed soil. Shall not be placed on unprepared fill material, organic soil, alluvial soil or mud. [Comm 21.40 (2) (b) 1. and HUD 3285.312 (a)]
5. 8 to 10” of clean graded sand, gravel or crushed stone base in clay soils [Comm 21.20 (2) with added thickness to resist frost.]
6. 6 mil vapor retarder overlapped 12 inches and sealed. [3285.204]
7. Maximum pier spacing of 7 feet with max load per pier of 5, 300 lbs [Comm 21.40 (2) (b) 10. and HUD 3285 (e), Table.]
8. Site shall drain away from the home per Comm 21.12.
9. The water table shall not be above the frost penetration depth, i.e. at least 4 feet below grade. [Comm 21.15 (2) (a)]